

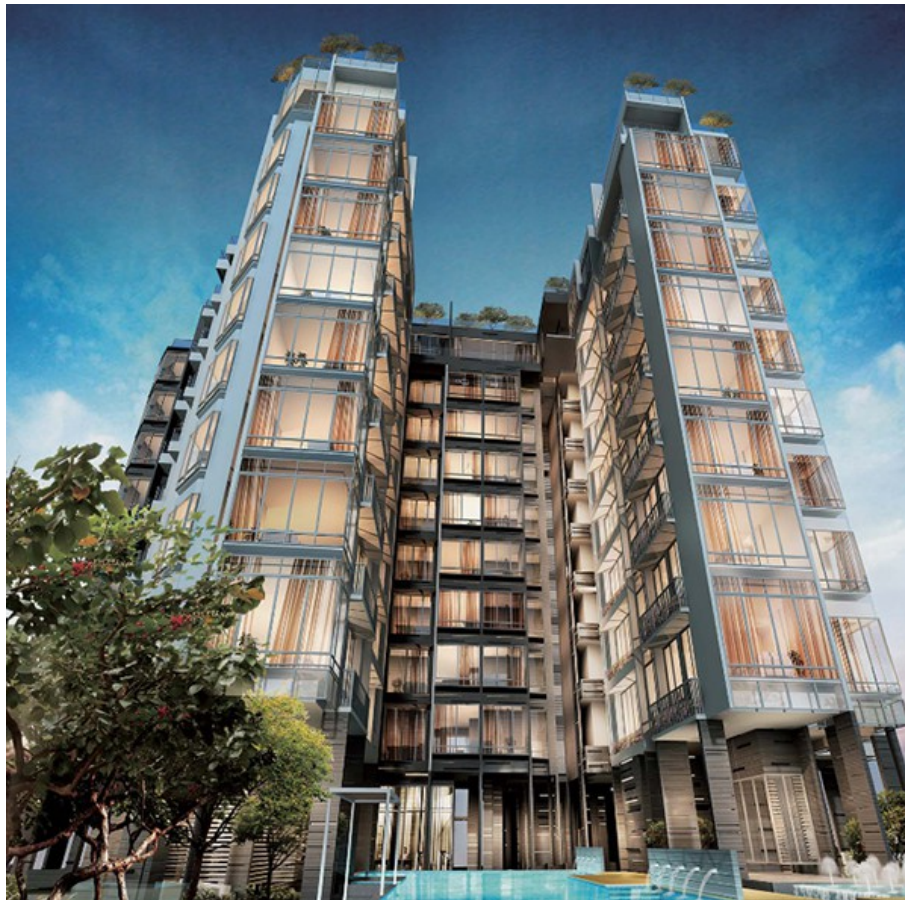

Home Loan | Commercial Loan | Refinance Loan | *Financial Planning
<http://www.iCompareLoan.com/>
+65 – 9782 – 8606

By [iCompareLoan Editorial Team](#)

Live the Dream at New Futura



New Futura is a novel, cutting-edge, two-block residential development perched at Leonie Hill Drive. As its name suggests, this new condo complex embodies futuristic design and the ideal lifestyle, perfect for the forward-thinking Singaporean sophisticate. All the comforts of modern living are within easy reach: shopping centers, supermarkets, schools, hospitals, parks, and others. It's also just a short drive from key locations such as the CBD, Marina Bay, Orchard Road, and Sentosa Island. The targeted completion date is in the year 2017.

[Join us](#) | [Login for Financial Advisors](#) |

SMS us at +65 – 9782 - 8606

Home Loan | Commercial Loan | Refinance Loan | *Financial Planning | *Insurance



New Futura's Award-Winning Design Concept

The development is intended to be an iconic architectural work across the skyline. Two high-rise buildings will stand imposingly with its groundbreaking design, like massive works of modern art, connected by gracefully curving sky bridges. New Futura is proposed to possess a visually elegant yet stable form, with a bold, vertical stature intermingled with sleek, horizontal lines created by aluminum structures. Peeping at intervals throughout both towers will be the lush foliage of the sky gardens.

This radical design is the brainchild of ADDP Architects, an acclaimed and multi-awarded firm that has rolled out a considerable number of remarkable projects for the past two decades. The concept will be made incarnate by Darages Singapore, the top construction and engineering company in Southeast Asia.

New Futura is an enterprise of City Sunshine Holdings, Pte., Ltd., a branch of City Developments Limited. CDL is a reputable real estate developer with years of experience and a diverse portfolio, creating properties with a distinctive concern for the community, environment, and the future.

New Futura has thus been bestowed with the coveted BCA Green Mark Gold Plus for its overall eco-friendly, environmentally sustainable model

Location

The site is on 14 Leonie Hill Drive, at the heart of the Core Central Region. It's in a quiet neighborhood enveloped by tranquil housing zones, near hospitals, shopping centres and schools. It's very well connected to main thoroughfares like the PIE, the CTE, and the AYE, so you won't have any trouble getting to the other parts of the island.

Just within a short walk from the site are two MRT Stations, namely the Somerset and Orchard Stations. The upcoming Great World City Station will also be serving the area in the near future, granting even more accessibility and connectivity.

Comfortable Living

[Join us](#) | [Login for Financial Advisors](#) |

SMS us at +65 – 9782 - 8606

Home Loan | Commercial Loan | Refinance Loan | *Financial Planning | *Insurance



The development will be comprised of 126 units, distributed among the 36 floors of its two towers. Each home will have ample living space for the whole family, including a spacious family room, a designer kitchen and dining area, and luxurious bedrooms. Expect high-end, branded fixtures and appliances, as well as elegantly finished interiors.

In-house Amenities and Recreational Offerings

New Futura will have a full range of perks and privileges for its residents, including a vast leisure pool, a tennis court, barbecue pits, an indoor gym, a fitness area, and sky gardens. The development will also have a grand lobby, basement parking, and sky bridges.

Nearby Shopping and Entertainment

A slew of malls are within a short walk or a quick drive. Just a couple of blocks away are Great World City and Valley Point, where you can find shops, boutiques, salons, restaurants and others. Also close by is the world-famous Orchard Road, where you have malls like Wisma Atria, The Heeren, Paragon, and The Centrepont. You won't have a shortage of cinemas, dining places, or leisure activities.

There are also a lot of supermarkets near you, like Sheng Shion, Giant, NTUC, and Cold Storage. You can easily swing by whenever you need to restock your pantry.

Other Recreational Hubs

Country clubs and golf clubs abound – Pines Club, Tanglin Golf Course, Tanglin Club, The American Club, as well as Safra Town Club.

But let's not overlook the value of a good, old-fashioned park. Just nearby are Istana Park, Hong Lim Park, Pearls Hill City Park, Tiong Bahru Park, and the historic Fort Canning Park.

If you don't mind a 15-minute drive, you can take your family for a weekend off at the Art Science Museum, the Singapore Flyer, Gardens By the Bay, Marina Bay Sands, Resorts World Sentosa, or Universal Studios.



Nearby Dining Choices

The surrounding areas are peppered with all sorts of eateries, from fancy restaurants to fast-food stops, especially around Orchard Road. Furthermore, there are a lot of food centers and hawker markets nearby, like Zion Riverside Market, Hong Lim Market and Food Center, People's Park Complex, or Tiong Bahru Market. You'll also find something good at Havelock Road Blk 22A, Chinatown, Bukit Merah View Blk 115, or Beo Crescent Blk 38A.

Nearby Hospitals

Living near a good hospital is always an advantage, especially if you have little children or senior citizens in your household. As an added bonus New Futura is within proximity to more than one hospital and a handful of clinics, including Camden Medical Center, Gleneagles Hospital, and Mount Elizabeth Hospital.

Nearby Schools

Provide a better, brighter future for your children by giving them the gift of education. You can start as early as pre-school. Just nearby are JHS Montessori, PCF Care Services, Wee Care, Kay Poh Road Baptist Kindergarten, and Little Hands Montessori.

Or choose among the many primary schools in the area: Alexandra Primary, River Valley Primary, Anglo-Chinese School Junior, Zhangde Primary, or St. Margaret's.

For their secondary or high school years, your kids can go to Grescent Girls School, Henderson Secondary, Delta Secondary, Gan Eng Seng, Raffles Girls School, Outram Secondary, Dhoby Ghaut Secondary, or Queenstown Secondary.

If you would like your kids to be educated under an international curriculum, you'd be so glad there are a lot on international schools so close to Leonie Hill. There's Eton House International Pre-school, Chatsworth International School (Orchard Campus), Stamford International School, International School Singapore, and KB International School.



Home Loan | Commercial Loan | Refinance Loan | *Financial Planning
<http://www.iCompareLoan.com/>
+65 – 9782 – 8606

As for colleges and tertiary institutions, there's Elite International College, Dimensions International College, Singapore Management University, Nanyang Acedemy of Fine Arts, and the University of Chicago-Booth.

Everybody wants to live the good life: a posh home in a comfortable location, with proximity to all sorts of entertainment and dining options. You can make this possible at New Futura! So be sure to plan ahead for your future: Contact iCompareLoan mortgage broker, so you can compare Singapore housing loans in the most advantageous way possible.

For advice on a new loan, go [here](#).

For refinancing advice, go [here](#).

Read more articles at

PropertyBuyer.com.sg/articles

SingaporeHomeLoan.net/blog/

iCompareLoan.com/resources/category/faq/

[Join us](#) | [Login for Financial Advisors](#) |

SMS us at +65 – 9782 - 8606

Home Loan | Commercial Loan | Refinance Loan | *Financial Planning | *Insurance



Home Loan | Commercial Loan | Refinance Loan | *Financial Planning
<http://www.iCompareLoan.com/>
+65 – 9782 – 8606

About www.iCompareLoan.com Mortgage Consultants

iCompareLoan Mortgage Consultants is a research focused independent mortgage broker. We emphasize a consultative approach where we match our client's financial situation with the best fit mortgage loan, not simply a cheap loan.

Paul Ho is the editor of www.PropertyBuyer.com.sg, www.iCompareloan.com and www.SingaporeHomeLoan.net and he holds a Masters of Business Administration from a reputable university. He is passionate about helping people enhance their wealth through financial literacy and in making money work harder for them.

Email: sales@iCompareLoan.com

Tel: 6100 – 0608

SMS: 9782 – 8606

For agents, mortgage brokers and financial advisors, subscribe to the [Home Loan Report™](#) at iCompareLoan and impress your clients with detailed home loan analyses which facilitate property buying and selling.

Copyright ® - All articles are the copyright of www.iCompareLoan.com and CoreConcept Systems Pte Ltd and the company reserves full rights to use, reuse in any form or in any media including rights of attribution and credits of articles.

[Join us](#) | [Login for Financial Advisors](#) |

SMS us at +65 – 9782 - 8606

Home Loan | Commercial Loan | Refinance Loan | *Financial Planning | *Insurance