

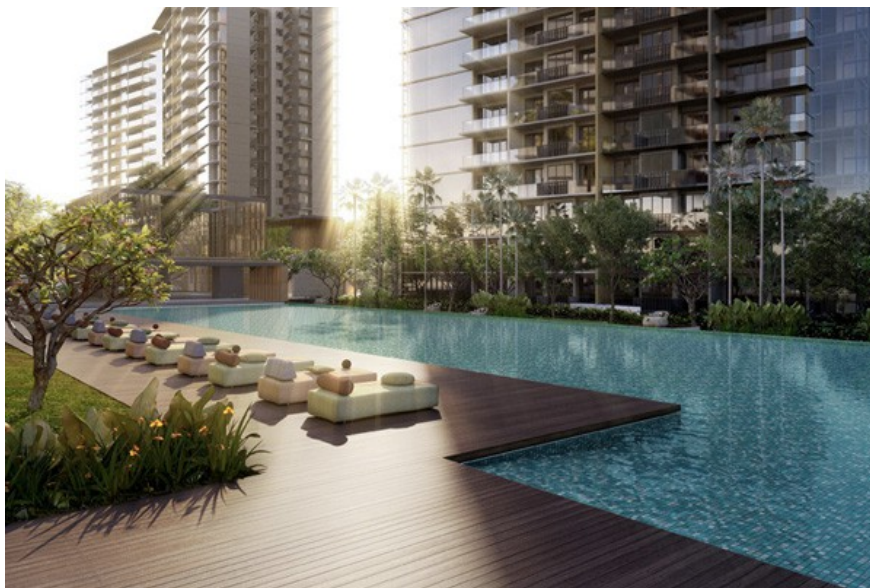

By [iCompareLoan Editorial Team](#)

The Landmark – Impressively Beautiful & Luxurious



The Landmark is an upcoming residential project that will spring to life at 173 Chin Swee Rd, on the place of the former LandMark Tower. With a site area of 6,200sqm and 396 units of 1 to 3 bedrooms, this iconic building will have 39 storeys towering over Chinatown.

Residents of the Landmark will be able to enjoy exquisite views, with Chinatown and Tanjong Pagar in the SouthEast, Marina Bay in the NorthEast, and the entire Pearl's Hill City Park sprawled in front of the complex.

Located in District 3, this new development is placed in a prime location of Singapore, close to multiple city venues. As a resident in the Landmark, you'll have quick access to the Central Business District, Marina Bay, Chinatown, Robertson Walk, Great World City or the UE Square. You'll be able to enjoy an exquisite panorama, having an unimpeded 360-degree panoramic view of the Marina Bay and the park.

[Join us](#) | [Login for Financial Advisors](#) |

SMS us at +65 – 9782 - 8606

Home Loan | Commercial Loan | Refinance Loan | *Financial Planning | *Insurance



Located in the close proximity of this place are numerous schools, MRT lines, and restaurants. This place is perfect for both parents with kids who want to live in the centre of the town, or for investors who want to rent out this place to high-earning expats. As an expat, you couldn't wish for a better location right in the heart of Singapore. **Luxury Residential Complex with Flawless Panorama**

One of the strongest selling points about this complex is the view you can enjoy all day long. If you are one of those select people who enjoy city life, you'll fall in love with this complex instantly. During the day, the view over the park and the Marina Bay are breathtaking. At night, the millions of lights are turning the Chinatown and Central Business District into dreamy, marvellous places.

This vibrant part of Singapore features the Pearl's Hill City Park right at your doorsteps, so you can relax and unwind far away from the hustle of the city. The perfect blend of urban life and natural areas offer mesmerizing views and enable you to live a balanced life, where work and business mingle perfectly with relaxation, fun and healthy living. **High Connectivity Locations**

Another strong selling point about this place is the perfect location, right in the centre of the city. This makes it very easy for you to travel to any area of Singapore, with the Chinatown MRT close by, as well as Outram Park MRT in the close proximity. This means you can quickly hop on the metro and travel on the East-West and North-East lines anywhere in the city.

If you prefer to drive, you can reach the Central Business District within 10 minutes. Thanks to its close proximity to major expressways, such as the Ayer Rajah Expressway, Central Expressway or Marina Coastal Expressway, The Landmark is the perfect location for car owners who want to save precious minutes driving to work, to the mall or to the airport. **Wide Range of Facilities & Amenities**

The Landmark is a complex that is close to a multitude of facilities, such as schools, restaurants, malls and cultural buildings. If you have kids, you don't have to worry about their education, as they can go to the best schools in the city, such as the Outram Secondary School, River Valley



Primary School, SMU, or Eton House International School.

If you love shopping, know that you have countless shopping options nearby. The Central Mall, People’s Park Complex, UE Shopping Mall, Liang Court and Chinatown Point are just minutes away, while the Jalan Kukoh Market, People’s Park Food Complex and Hong Lim Food Ctr are within close proximity of the location. **Premium Facilities**

This new residential complex also comes with some premium features, such as gym, sky deck, lounge deck, swimming pool, rooftop observatory, gourmet lounge or lap pool. The developer, which is Landmark JV Pte Ltd., is a joint consortium of multiple companies that have developed countless famous residential and commercials units in Singapore, China and Malaysia.

With some of Singapore’s best developers overseeing this project, you can be assured that the Landmark will turn out to be an exceptional investment. If you want to check out the loans available for you, do not hesitate to use the services of iCompareLoan mortgage broker and compare Singapore housing loans.

For advice on a new loan, go [here](#).

For refinancing advice, go [here](#).

[Join us](#) | [Login for Financial Advisors](#) |

SMS us at +65 – 9782 - 8606

Home Loan | Commercial Loan | Refinance Loan | *Financial Planning | *Insurance



Home Loan | Commercial Loan | Refinance Loan | *Financial Planning
<http://www.iCompareLoan.com/>
+65 – 9782 – 8606

Read more articles at

PropertyBuyer.com.sg/articles

SingaporeHomeLoan.net/blog/

iCompareLoan.com/resources/category/faq/

[Join us](#) | [Login for Financial Advisors](#) |

SMS us at +65 – 9782 - 8606

Home Loan | Commercial Loan | Refinance Loan | *Financial Planning | *Insurance



Home Loan | Commercial Loan | Refinance Loan | *Financial Planning
<http://www.iCompareLoan.com/>
+65 – 9782 – 8606

About www.iCompareLoan.com Mortgage Consultants

iCompareLoan Mortgage Consultants is a research focused independent mortgage broker. We emphasize a consultative approach where we match our client's financial situation with the best fit mortgage loan, not simply a cheap loan.

Paul Ho is the editor of www.PropertyBuyer.com.sg, www.iCompareloan.com and www.SingaporeHomeLoan.net and he holds a Masters of Business Administration from a reputable university. He is passionate about helping people enhance their wealth through financial literacy and in making money work harder for them.

Email: sales@iCompareLoan.com

Tel: 6100 – 0608

SMS: 9782 – 8606

For agents, mortgage brokers and financial advisors, subscribe to the [Home Loan Report™](#) at iCompareLoan and impress your clients with detailed home loan analyses which facilitate property buying and selling.

Copyright © - All articles are the copyright of www.iCompareLoan.com and CoreConcept Systems Pte Ltd and the company reserves full rights to use, reuse in any form or in any media including rights of attribution and credits of articles.

[Join us](#) | [Login for Financial Advisors](#) |

SMS us at +65 – 9782 - 8606

Home Loan | Commercial Loan | Refinance Loan | *Financial Planning | *Insurance